



32 Norbroom Drive, Newport, TF10 7TD
Offers In The Region Of £250,000

Located on the peaceful cul-de-sac of Norbroom Drive, this three-bedroom detached property offers a large living room, a modern fitted kitchen and a private rear garden with good off-road parking. Being sold with no upward chain, this property is ready to become your next home.

Entrance Hall

A cute little entrance hall, with stairs leading to the first floor and access to the living room.

Living Room

A very generous sized living room, yet still with a cosy feel. A large UPVC bay window overlooking the front garden, radiator and central light fitting. An internal part-glazed doorway into the dining room.

Dining Room



A good-sized dining area with a handy built-in storage cupboard and French doors out to the rear garden.

Kitchen

A modern, well-presented fitted kitchen featuring cream wall and base units, topped with plenty of wood-effect worksurface space, an integrated AEG hob and oven, fitted fridge-freezer and the added luxury of a separate drinks fridge. Other benefits include under-unit lighting, plumbing for a washing machine or dishwasher, sunken 1 & 1/2 sink and a side door for external access.

Stairs & Landing

A straight staircase leading to the first-floor landing, which houses the boiler cupboard and loft hatch.

Master Bedroom

A big, spacious double bedroom to the front of the property, with two UPVC windows, an alcove ideal for wardrobe space, a radiator and ceiling light fitting.

Bedroom Two



A second smaller double bedroom, with views over the rear garden through a UPVC window, carpeted floor, radiator and ceiling light fitting.

Bedroom Three

A single bedroom, with laminate wood flooring and a UPVC window with views to the rear of the property.

Bathroom

A large, central, family bathroom, featuring a fitted bathtub and overhead electric shower unit with modern tiled surrounding walls. A grey pedestal basin and low-level flush WC. For added comfort and convenience, there is a chrome, heated towel rail, extractor fan, frosted window and ceiling spotlights.

Garden & Driveway

The garden benefits from being private and not overlooked at the rear, with planted borders of shrubs and flowers, and areas laid to lawn and patio; there is also a small lawn area to the front of the property. There is side access from the driveway to the garden via a gateway. The driveway can accommodate multiple cars. There is a flat-roof, single brick-built garage for added storage space.

Floor Plan

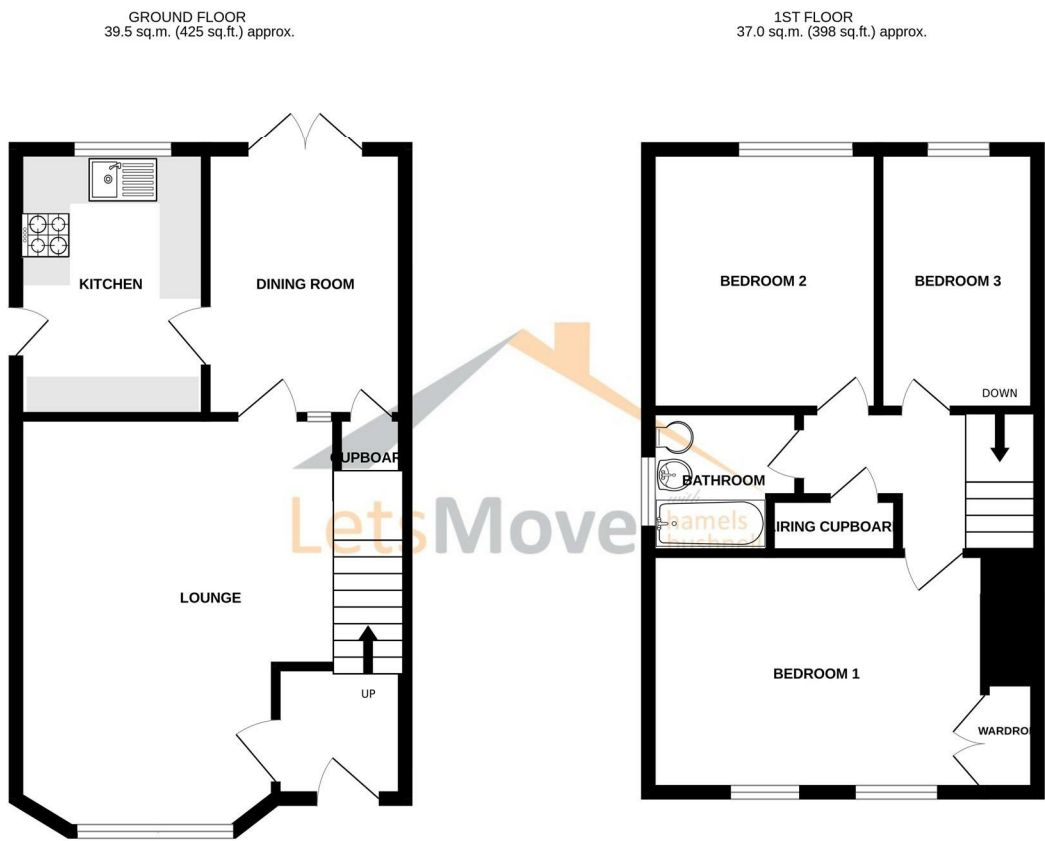

TOTAL FLOOR AREA : 76.5 sq.m. (824 sq.ft.) approx.
Measurements are approximate. Not to scale. Illustrative purposes only
Made with Metropix ©2025

Area Map

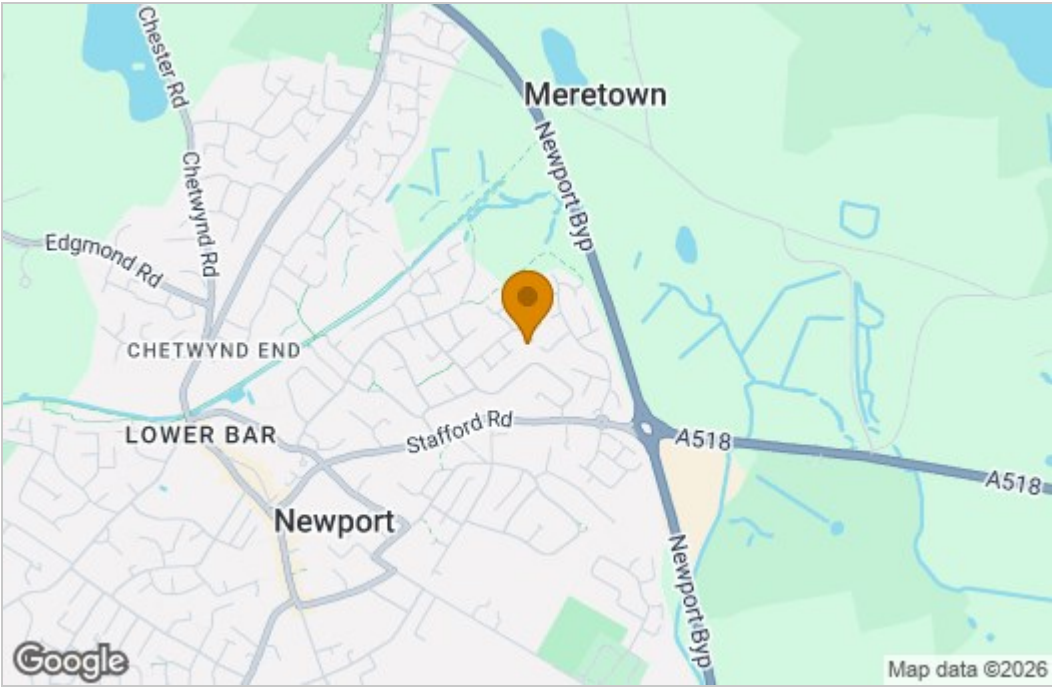

Energy Efficiency Graph

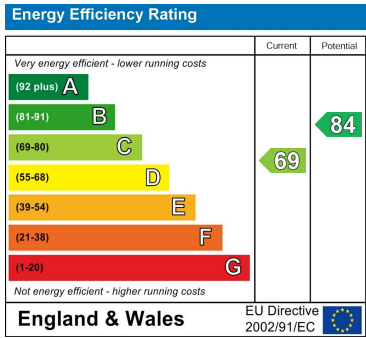

These particulars, whilst believed to be accurate are set out as a general outline only for guidance and do not constitute any part of an offer or contract. Intending purchasers should not rely on them as statements of representation of fact, but must satisfy themselves by inspection or otherwise as to their accuracy. No person in this firms employment has the authority to make or give any representation or warranty in respect of the property.